

REGION NO.	STATE	FEDERAL AID PROJECT NO.	SHEET NO.	TOTAL SHEETS
10	WASH.	BRS-D274(002)	1	2

CALL 2 WORKING DAYS BEFORE YOU DIG
1-800-424-5555
 UTILITIES UNDERGROUND LOCATION CENTER

BRIDGE #1172-C

288TH STREET SOUTH / LACAMAS CREEK

CRP 5733

RIGHT OF WAY PLANS

PAGE NO.	SHEET
1	COVER
2	PLAN

INDEX

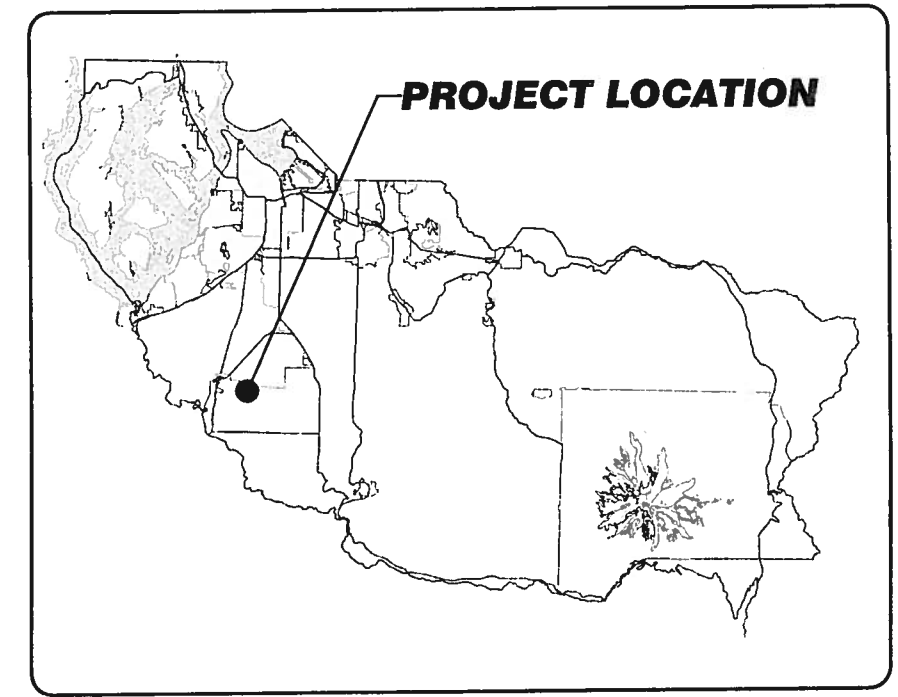

LOCATION MAP

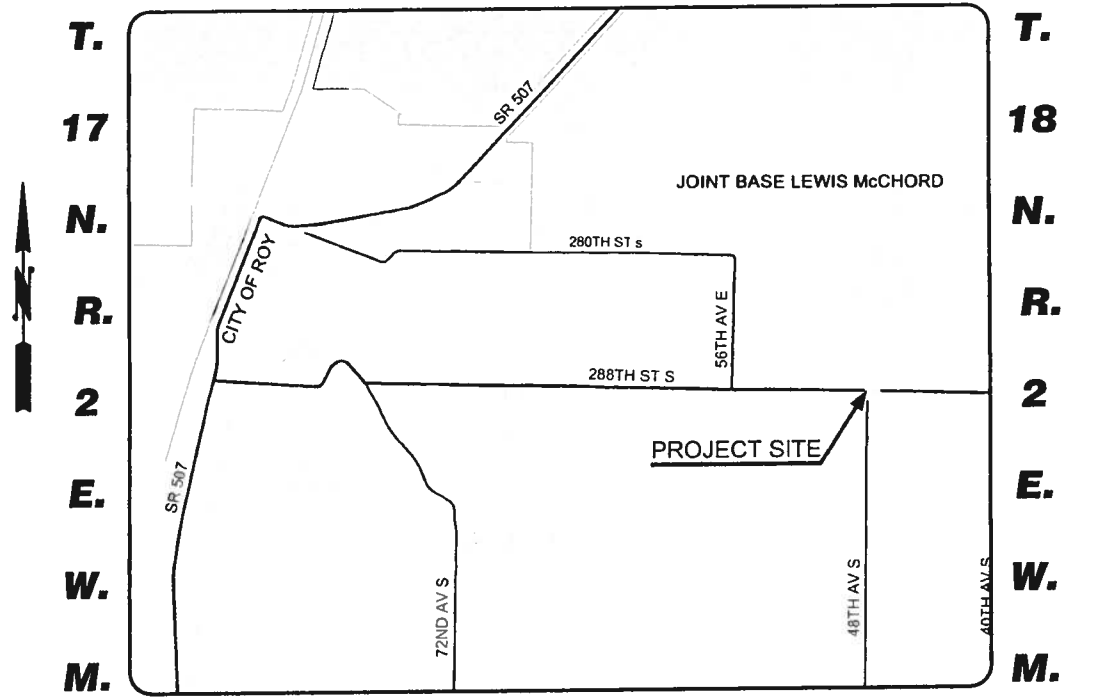

VICINITY MAP

Drawing: P:\5733-BR1172C-288STSBRIDGERIGHTOFWAY\PLANSHEETS\5733 RW COVER.DWG Layout Tab: COVERSHEET
 Xref: Date: 08/15/2013 Time: 01:22:59 PM Plotted by: GSERVIS

DRAWN BY: G. SERVISS, P.E.	BOOK NO: HC1
DESIGNED BY: R. RUSSOM, P.E.	SURVEYED BY: D. AUCKLAND
CHECKED BY: G. AMUNDSEN, P.E.	DATE SURVEYED: 01/16/13
REVIEWED BY: K. SHANER, P.E.	DATE PLOTTED: August 15, 2013

NO.	DATE	REVISION	BY	APPROVED

Pierce County
 Public Works and Utilities
 Office of the County Engineer
 Tacoma Mall Office Building
 4301 South Pine Street, Suite 628
 Tacoma, Washington 98409-7207
An APWA Accredited Agency

8/15/13
 Office of the County Engineer
 APPROVED BY:
 8-15-13
 BRIAN D. STACY, P.E. DATE
 JERRY P. BRYANT, P.E.
 FIELD ENGINEERING MANAGER

BRIDGE #1172-C
288TH STREET SOUTH / LACAMAS CREEK

COVER

CRP 5733

T. 18 N., R. 2 E., W. M.

REGION NO.	STATE	FEDERAL AID PROJECT NO.	SHEET NO.	TOTAL SHEETS
10	WASH.	BRS-D274(002)	2	2

CALL 2 WORKING DAYS BEFORE YOU DIG
1-800-424-5555
 UTILITIES UNDERGROUND LOCATION CENTER

END PROJECT
 STA. "R/Wb" 12+80.00

SW 1/4 SE 1/4
 SEC. 36

NW 1/4 NE 1/4
 SEC. 1

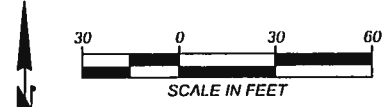

SE 1/4 SW 1/4
 SEC. 36

S 88°44'58" E 2650.35
 Fd. 3" Surface Brassie
 LS# 18922 B-2008
 NW Cor.
 Sec. 1 T17N R2E
 Date Visited 1-14-09

NE 1/4 NW 1/4
 SEC. 1

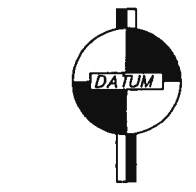

BASIS OF BEARING FROM
 PIERCE COUNTY CORS NETWORK
 NAD 83 (CORS 960)
 NAD 83 (HARN 91)
 HORIZONTAL DATUM: NAD 1983-1991
 VERTICAL DATUM: N.A.V.D. 88

REFERENCES
 Deeds: 60' Est. V. 5 Pg. 273
 (11-16-1887), 40' Est. V. 5 Pg. 55
 (11-13-1886),
 30' Waivers AFN 448459, AFN 448460,
 QCD AFN 8805250311
 Large Lot: AFN 8408240327, AFN
 8806130534

Short Plat: AFN 9203230132
 Record of Surveys: AFN 9506270737,
 AFN 200802135003, AFN 200809185005
 Maps & Plans: 48th Av. S. 1924
 (Pincus County Rd.),
 48th Av. S. Bridge #1172-C 1936
 Field Books: 856, 589

BEGIN PROJECT
 STA. "R/Wb" 5+46.30

6+00 288TH STREET SOUTH
 (ROY-RONDO COUNTY ROAD)

"R/Wb" LINE = SECTION LINE = R/W CENTERLINE

8+00

S 88°44'58" E 453.70'

STA "R/Wb" 10+00.00 =
 STA "R/Wa" 10+00.00

0217012007
 GINGRICH
 JACK & CHARLENE
 28908 - 48TH AV S

Loveland Mutual Power Line Esm't.
 Over and Across this Parcel AFN 1289682

S 58°14'47" E 498.30'
 (ROAD ABANDONED)
 SEE COUNTY ENGINEER'S ROAD FILE

N 06°45'13" E 254.10'
 S 00°39'54" W 2707.11'
 48TH AVENUE SOUTH 8+00
 R/Wb LINE = R/W CENTERLINE

Fd. 3" Surface Brassie
 LS# 18922 B-2008
 N 1/4 Cor. Sec. 1
 Date Visited 1-14-09

STA "R/Wb" 9+95.82
 (52.02' LT)

STA "R/Wb" 9+95.70
 (30.00' LT)

STA "R/Wb" 11+11.53
 (52.00' LT)

STA "R/Wb" 11+11.53
 (30.00' LT)

8280
 JOINT BASE
 LEWIS McCHORD

STA "R/Wb" 10+64.54
 (35.00' RT)

STA "R/Wb" 10+79.35
 (58.79' RT)

STA "R/Wb" 10+99.00
 (35.00' RT)

12+00

S 88°27'01" E 2666.53'

Fd. 3" Surface Brassie
 LS# 18922 B-2008
 NE Cor. Sec. 1 T17N R2E
 Date Visited 1-14-09

STA "R/Wb" 12+07.00
 (35.00' RT)

STA "R/Wb" 12+07.00
 (43.00' RT)

STA "R/Wb" 11+47.00
 (43.00' RT)

STA "R/Wb" 10+99.00
 (43.00' RT)

STA "R/Wb" 11+12.47
 (77.92' RT)

STA "R/Wb" 10+50.86
 (35.00' RT)

STA "R/Wb" 10+30.86
 (55.31' RT)

STA "R/Wb" 10+71.85
 (119.00' RT)

STA "R/Wb" 10+31.84
 (119.00' RT)

Pacific Telephone & Telegraph Esm't.
 Over and Across this Parcel AFN 1789576

8283A
 0217015002
 TENNYSON
 HOWARD & JEANNE
 4620 - 288TH ST E

8281A
 0217015007
 CARROLL
 PAUL & DEBORAH
 XXX - 48TH AV S

EXISTING LEGEND

	RIGHT-OF-WAY CENTERLINE
	RIGHT-OF-WAY LINE
	PROPERTY LINE
	PERMANENT EASEMENT
	ABANDONED RIGHT-OF-WAY CENTERLINE
	ABANDONED RIGHT-OF-WAY LINE
	GUARDRAIL
	EDGE OF ASPHALT
	EDGE OF GRAVEL
	STREAM EDGE
	STRUCTURE
	FENCE

PROPOSED LEGEND

	TEMPORARY EASEMENT
	SLOPE EASEMENT

T. 17 N., R. 2 E., W. M.

BEGIN PROJECT
 STA. "R/Wa" 7+00.00

Line Table

Line #	Length	Direction
L1	28.03	S 30°21'39.46" E

Curve Table

Curve #	Length	Radius	Delta
C1	31.72	20.00	90°53'04.71"

NOTE:
 PROPERTY LINES OF THE ADJACENT PARCELS SHOWN
 ON THESE PLANS ARE LOCATED BY INTERPRETATION OF
 DEEDS AND OTHER INFORMATION FOUND IN THE
 PUBLIC RECORD AND SHOULD NOT BE CONSTRUED AS
 AN ACTUAL SURVEY.

Ownership Table

Parcel No.	Name	Total Area (SF)	Temporary Esm't (SF)	Slope Esm't (SF)	Remainder (SF)
8280	Joint Base Lewis McChord	---	2,552	---	---
8281A	Carroll, Paul Jr. & Deborah	118,483	4,623	---	118,483
8283A	Tennyson, Howard & Jeanne	43,560	1,776	864	43,560

DRAWN BY: G. SERVIS, P.E.	BOOK NO. HC1
DESIGNED BY: R. RUSSOM, P.E.	SURVEYED BY: D. AUCLAND
CHECKED BY: G. AMUNDSEN, P.E.	DATE SURVEYED: 01/16/13
REVIEWED BY: K. SHANER, P.E.	DATE PLOTTED: August 15 2013

NO	DATE	REVISION	BY	APPROVED

Pierce County
 Public Works and Utilities
 Office of the County Engineer
 Tacoma Mall Office Building
 4301 South Pine Street, Suite 628
 Tacoma, Washington 98409-7207
 An APWA Accredited Agency

8/15/13
 Office of the County Engineer
 APPROVED BY:

 BRIAN D. STACY, P.E. DATE
 JERRY P. BRYANT, P.E.
 FIELD ENGINEERING MANAGER

BRIDGE #1172-C
288TH STREET SOUTH / LACAMAS CREEK
PLAN
CRP 5733

Drawing: P:\5733-BR1172-C\BRIDGE\DRAWINGS\RIGHTOFWAY\PLANSHEET\5733-RW-PLAN.DWG Layout: Tab. RW PLAN
 Xrefs: 5733_T0POND.DWG; 5733_BRIGHTOFWAY_PROPOSED.DWG; 5733_RIGHTOFWAYINDEX.DWG
 Date: 08/15/2013 Time: 01:43:04 PM Plotted by: GSERVIS