



# Concrete Porches

## Bulletin 9

Division of Building, Safety, and Inspection for 2018 International Codes

All untreated wood products must be a minimum of 6 inches above grade (earth) and 2 inches above a concrete patio, walk, or drive.

For wood products to be in contact with earth or concrete, they must be naturally durable wood or wood that is preservative-treated. The following are typical details that afford protection.

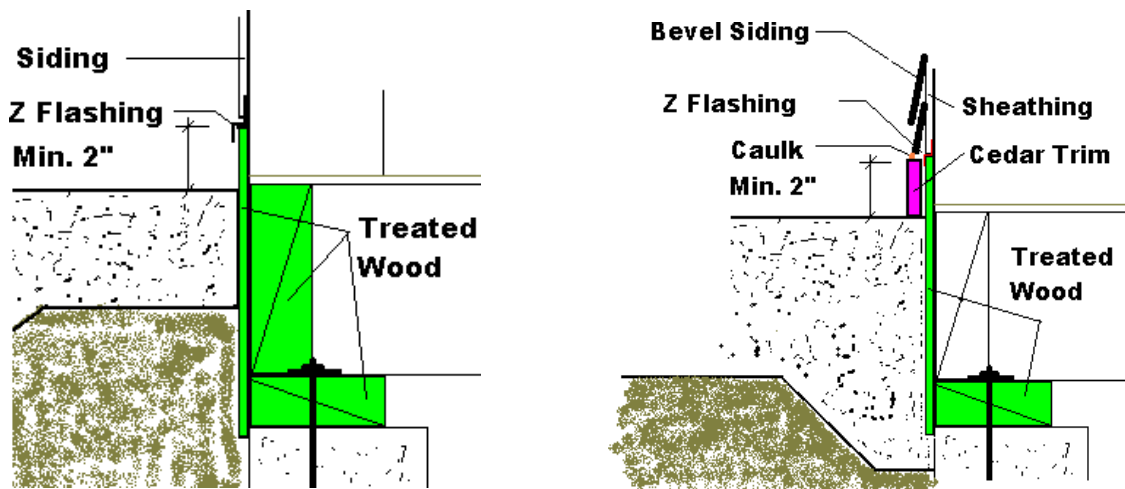

Vinyl membrane and galvanized flashing should extend from a point 3 inches above the concrete porch surface to a minimum of 3 inches below the top of the foundation wall.

