

**SUNRISE**  
**MASTER PLAN**  
**5 YEAR PLAN UPDATE-- 2021**  
**LAND USE and ZONING MAP**  
**FINAL SITE PLAN AS OF 08-20-21**

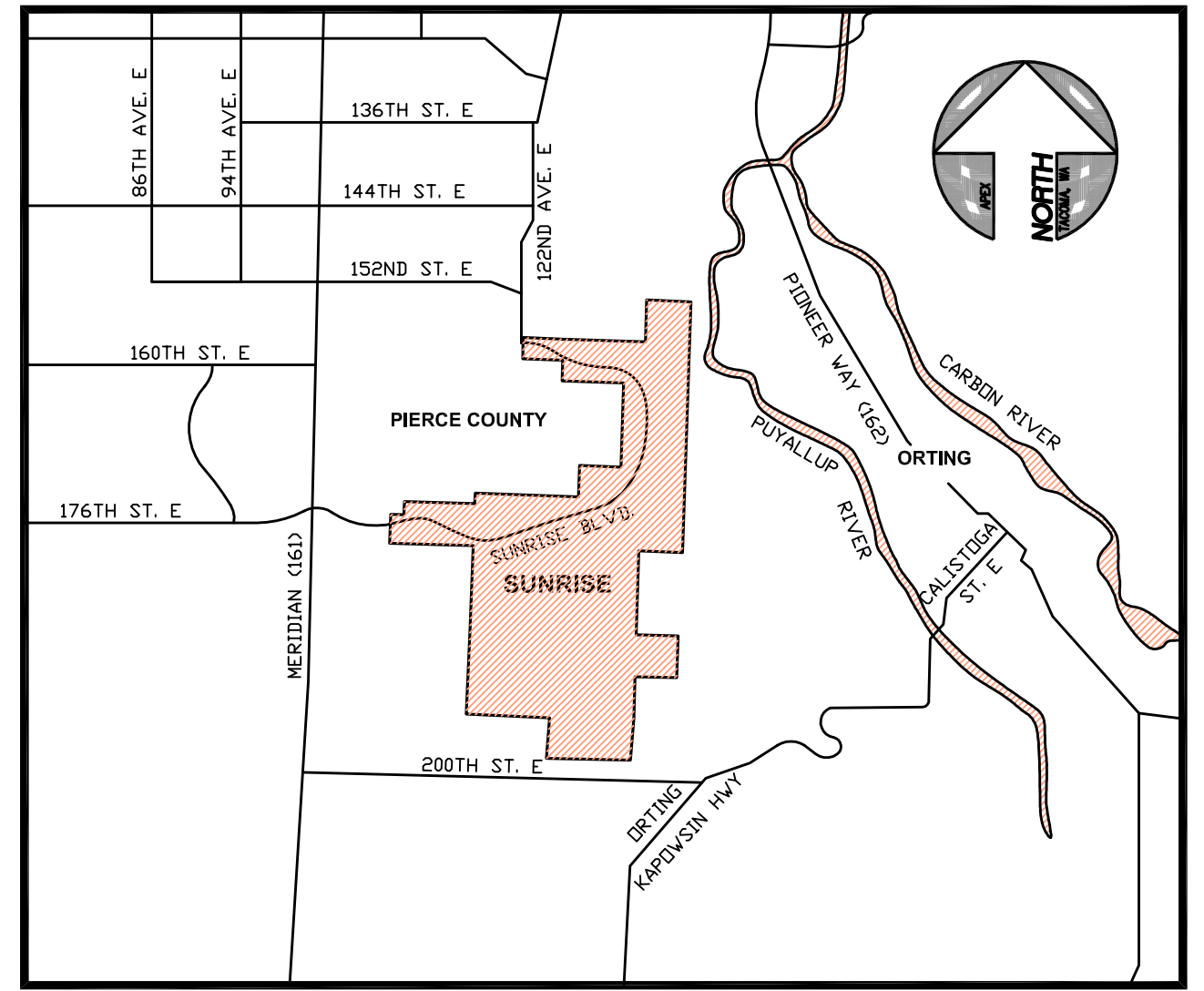

**VICINITY MAP**  
NOT TO SCALE

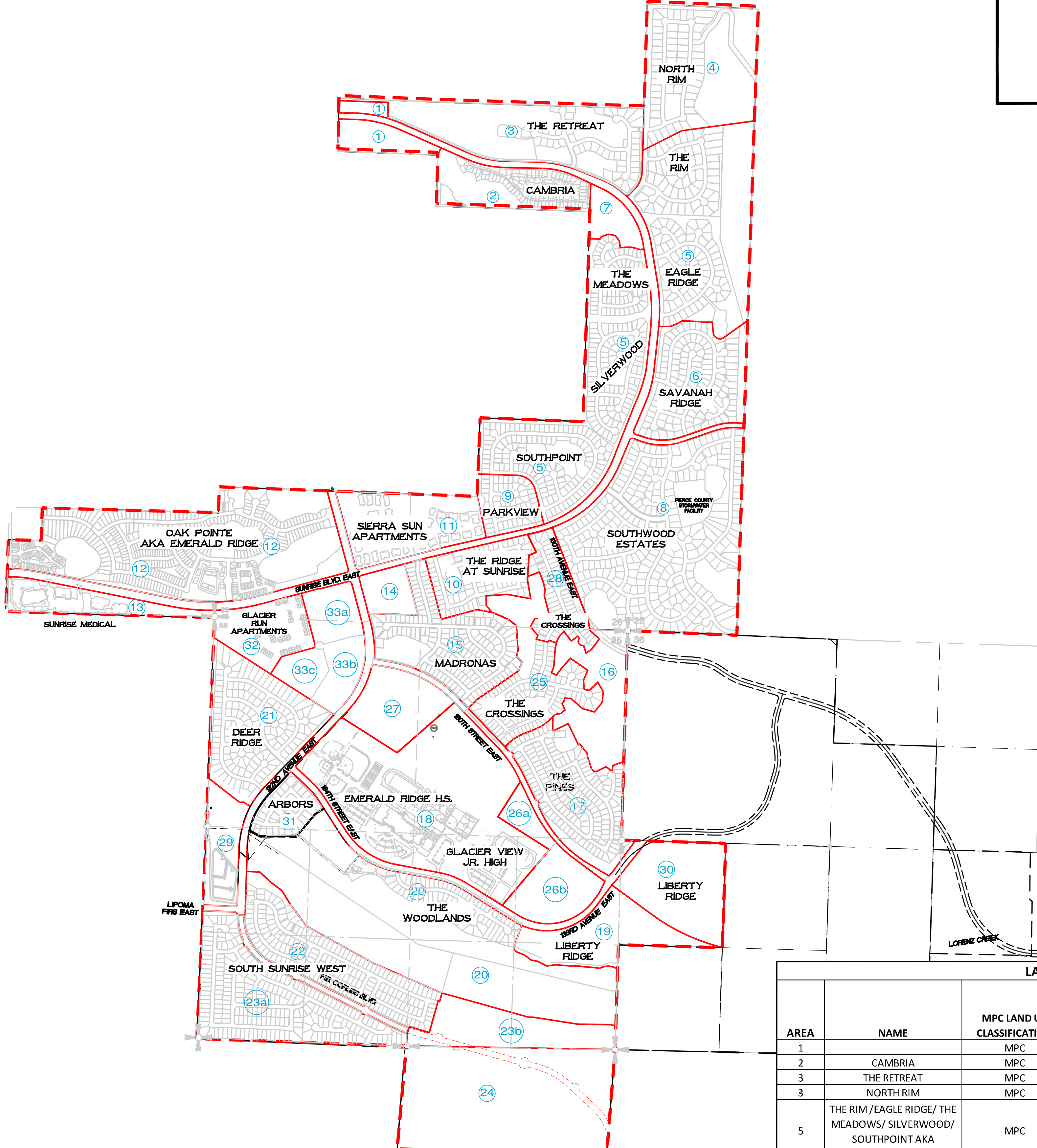

LAND USE AND ZONING TABLE						
AREA	NAME	MPC LAND USE CLASSIFICATIONS	MPC ZONING CLASSIFICATIONS	APPROVED OR EXISTING SINGLE FAMILY UNITS /PADS	APPROVED OR EXISTING MULTI-FAMILY UNITS /PADS	ACRES
1		MPC	MSF			20.2
2	CAMBRIA	MPC	HRD	93		25
3	THE RETREAT	MPC	MSF	49		50.5
3	NORTH RIM	MPC	MSF	63		40.5
5	THE RIM /EAGLE RIDGE/ THE MEADOWS/ SILVERWOOD/ SOUTHPOINT AKA TANGLEWOOD	MPC	MSF	424		162.7
6	SAVANNAH RIDGE	MPC	MSF	122		38.5
2		MPC	MSF			7.85
8	SOUTHWOOD ESTATES	MPC	MSF	292		109.6
9	PARKVIEW AKA SOUTHPOINT	MPC	MSF	48		11.6
10	THE RIDGE	MPC	MSF	88		22
11	SIERRA SUN APARTMENTS	MPC	MUD		249	80.2
12	OAK POINT AKA EMERALD RIDGE	MPC	HRD	334	301	60.6
10	SUNRISE MEDICAL	MPC	UNC			15.8
10		MPC	CC			8.01
10	THE MADRONAS	MPC	MSF	162		37.27
16	THE CROSSINGS	MPC	MSF	SEE AREA 25		24.73
17	THE PINES	MPC	MSF	162		35.2
10	PUYALLUP SCHOOL DISTRICT	MPC				100.1
10	LIBERTY RIDGE	MPC	MSF			25.4
20	THE WOODLANDS	MPC	MSF	67		113.3
21	DEER RIDGE	MPC	MSF	145		41.8
22	SOUTH SUNRISE WEST	MPC	MSF	179		38.19
23b	SOUTH SUNRISE WEST	MPC	MSF	216		54.66
23b		MPC	MSF			25.23
20		MPC	MSF			78.12
20	THE CROSSINGS	MPC	MSF	180		31.16
26a		MPC	HRD			5.5
26c		MPC	HRD			17.27
27		MPC	MUD			20
20	THE CROSSINGS	MPC	MSF	SEE AREA 25		13.75
20	SOUTH SUNRISE POND	MPC	MSF			11.44
30	LIBERTY RIDGE	MPC	MSF			31.87
31	THE ARBORS	MPC	MSF	33		10.5
32	GLACIER RUN	MPC	MUD		384	18.7
33a		MPC	CC			10.88
33c	SUNRISE REGIONAL PARK	MPC	CC			9.42
33c		MPC	CC			6.45
	POND IV-6					7.5
	POND IV-4					8
	WATER TANK					1.1
	ROADS & LINEAR PARK					36.4
			TOTAL ACRES			1467
			TOTAL UNITS TO DATE-	2667	934	
			TOTAL ALLOWED UNITS 4728			

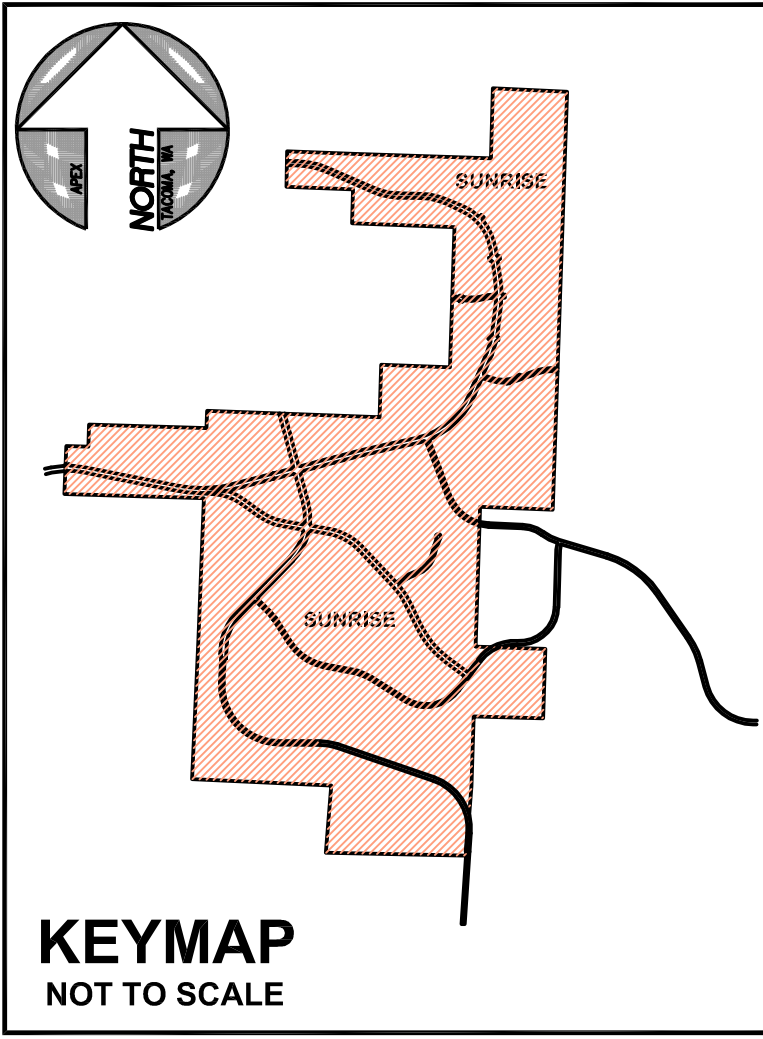

**KEYMAP**  
NOT TO SCALE

REV NO	REVISION DESCRIPTION	DATE	BY	DATE SEALED

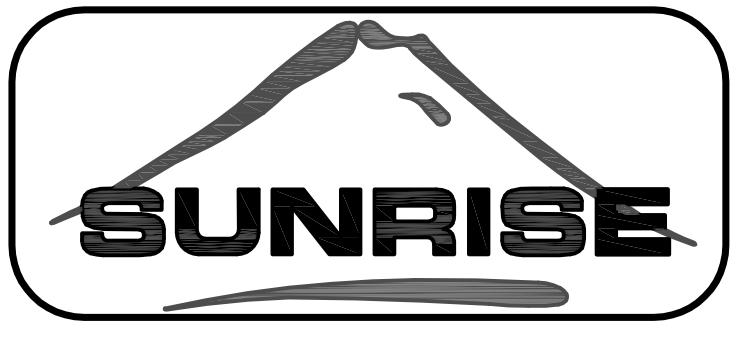

**TITLE** SUNRISE MASTER PLAN  
 5 YEAR PLAN UPDATE -- 2021  
 LAND USE and ZONING MAP  
 FINAL SITE PLAN AS OF 08-20-21  
**OWNER**  
 SUNRISE DEVELOPMENT CORPORATION  
 3106-A Sumner Tapps Hwy. E. Lake Tapps, WA 98391  
 (253) 826-5003 ATTN: ERIC CORLISS

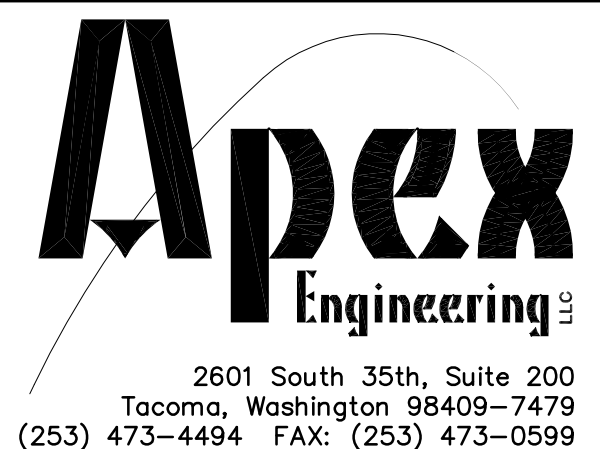

**PROJECT MANAGER**  
 COLLEEN HARRIS  
**DESIGN** KRS  
**DRAWN** KRS  
**CHECKED** KRS  
**DATE** 08-20-21  
**SCALE** 1"=800'  
**SHEET 1 OF 1**  
**FILE NO 35088**